



FEATURES

DIRECTLY REPLACES STANDARD INCANDESCENTS

- 10 YEAR / 100,000 HOURS
- SOLID STATE - HIGH SHOCK & VIBRATION RESISTANCE
- BUILT-IN CURRENT LIMITING RESISTOR FOR APPLICATIONS FOR 2V TO 130VAC
- HIGH INTENSITY ILLUMINATION
- LOW CURRENT-POWER SAVINGS 100 TO 500% AND MORE...
- CHOICE OF MULTICHIPS, DUAL-CHIPS & SINGLE CHIPS
- PILOT LIGHTS, INDUSTRIAL CONTROLS, LIGHTED PUSH-BUTTON SWITCHES, AUTOMOTIVE INDICATORS ETC.
- CHOICE OF 8 COLORS

T1¼ SUBMINATURE FLANGED BASED LEDs

REPLACES FOLLOWING INCANDESCENTS

PART NO:

F154 CR6-28V/20-P

MODEL #	LENS/COLOR/BRIGHT	VOLTS/mAmps Typ	FEATURES
MULTICHIP (4-CHIP) F154	CR3K,CR6,CR5,C05,CY5, CLY5,CG5,CPG5	4Vf, 8Vf = EXT. RES. REQD. 5V/25, 12V/12, 14V/12, 24V/12, 28V/10 Other Voltage/mAmps Available	CENTER CONTACT: P= POSITIVE + N= NEGATIVE - BP=BIPOLAR AC=VAC

F154

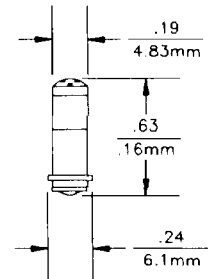

T2 (Ba5s) SUBMINATURE BAYONET BASED LEDs

REPLACES FOLLOWING INCANDESCENTS

PART NO:

B206 CR6-28V/20-P

MODEL #	LENS/COLOR/BRIGHT	VOLTS/mAmps Typ	FEATURES
MULTICHIP (6-CHIP) B206	CR3K,CR7,CR6,C06,CY6, CLY6,CG6,CPG6,CB6,CW6 SPECIALS: CRPG5=BICOLOR R/PG COPG6=BICOLOR O/PG	4Vf, 6Vf = EXT. RES. REQD. 5V/60,6V/60,12V/30,14V/30, 24V/20,28V/20,36V/15,48V/15, 60V/12,120VAC/8 Other Voltage/mAmps Available	CENTER CONTACT: P= POSITIVE + N= NEGATIVE - BP=BIPOLAR AC=VAC

B206 (Ba5s)

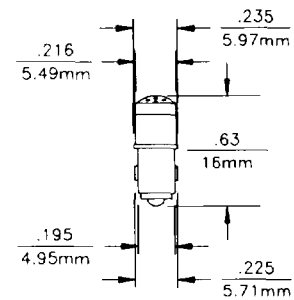

T2 (Ba7s) SUBMINATURE BAYONET BASED LEDs

REPLACES FOLLOWING INCANDESCENTS

PART NO:

B276 CR6-28V/20-P

MODEL #	LENS/COLOR/BRIGHT	VOLTS/mAmps Typ	FEATURES
MULTICHIP (6-CHIP) B276 = STANDARD BS276 = SHORT	CR3K,CR7,CR6,C06,CY6, CLY6,CG6,CPG6,CB6,CW6 SPECIALS: CRPG5=BICOLOR R/PG COPG6=BICOLOR O/PG	4Vf, 6Vf = EXT. RES. REQD. 5V/60,6V/60,12V/30,14V/30, 24V/20,28V/20,36V/15,48V/15, 60V/12,120VAC/8 Other Voltage/mAmps Available	CENTER CONTACT: P= POSITIVE + N= NEGATIVE - BP=BIPOLAR AC=VAC

B276 (Ba7s)

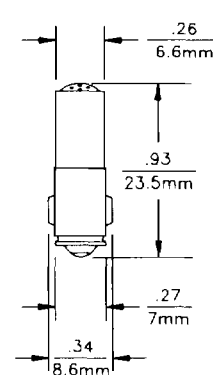

BS276 (Ba7s)

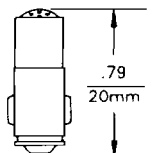

SPECIALS:

- FLASHING/BLINKING LEDs
- SUNLIGHT VISIBLE GaAlAs HI-ULTRA REDS
- LOW CURRENT 1mA TO 5mA LEDs FOR BATTERY OPERATION
- BICOLOR LEDs
- INFRARED 850, 880 & 940nm